

COUNTY COUNCIL OF CECIL COUNTY, MARYLAND  
LEGISLATIVE SESSION DAY 2022-04

RESOLUTION NO. 07-2022

**Title of Resolution:** Approval – Application – Enterprise Zone Expansion

**Synopsis:** A Resolution to expand the existing Cecil County Enterprise Zone by 391.86 acres, more or less.

**Introduced by:** Council President on behalf of the County Executive

**Introduced and ordered posted on:** February 15, 2022

**Public hearing scheduled on:** March 15, 2022 at 7:00 p.m.

**Scheduled for consideration on:** April 5, 2022

By:   
Council Manager

**PUBLIC HEARING**

Notice and title of Resolution having been posted on February 15, 2022 at the County Administration Building, 200 Chesapeake Blvd., Elkton and having been published according to the Charter on March 2, 2022 and March 9, 2022, a public hearing was held on March 15, 2022, and concluded on March 15, 2022.

By:   
Council Manager

**Explanation:** CAPITAL LETTERS INDICATE LANGUAGE ADDED TO EXISTING DOCUMENT  
~~Strike through~~ indicates language deleted from existing document  
Underlining indicates language added to document by amendment.  
~~Double Strike through~~ indicates language stricken from document by amendment

1           **WHEREAS**, Maryland’s Enterprise Tax Credit Program is a joint effort between the State  
2 and local governments to provide tax incentives to businesses and property-owners located in  
3 economically distressed communities; and

4           **WHEREAS**, the Cecil County Enterprise Zone was approved by the State of Maryland on  
5 June 15, 2013, thus providing an important economic development tool for the County and the  
6 towns of Perryville, North East and Elkton; and

7           **WHEREAS**, the Cecil County Office of Economic Development desires to have the  
8 current Enterprise Zone expanded to allow existing businesses in Cecil County and prospective  
9 new businesses to utilize these incentives; and

10           **WHEREAS**, the application will include all those seven (7) properties shown on the  
11 attached map and associated parcel listing in Exhibit A, in all totaling 391.86 acres, more or less;  
12 and

13           **WHEREAS**, the primary benefits to businesses that are located within an enterprise zone  
14 are eligibility for local property tax credits and State income tax credits; and

15           **WHEREAS**, eligible businesses in an enterprise zone may claim a ten-year credit against  
16 local real property taxes on a portion of real property improvements. The credit is 80 percent  
17 of the assessment increase during the first five years. The credit then decreases 10 percent  
18 annually thereafter to 30 percent in the tenth year; and

19           **WHEREAS**, eligible businesses in an enterprise zone may claim a one-time \$1,000  
20 income tax credit for wages paid to each new employee in a new position. For new  
21 economically disadvantaged employees, the credit increases to a total of \$6,000 per worker  
22 distributed over three years. Businesses claim the enterprise zone income tax credits on  
23 Maryland 500CR form when they submit their business or individual income tax returns to the  
24 Comptroller; and

25           **WHEREAS**, the Enterprise Zone is an important incentive for the County to encourage  
26 existing businesses to expand and in attracting new businesses to locate within Cecil County;  
27 and

28           **WHEREAS**, the application for the subject Enterprise Zone must be filed with the State  
29 of Maryland Department of Commerce on or before April 15, 2022.

30           **NOW, THEREFORE, BE IT HEREBY RESOLVED BY THE COUNTY COUNCIL OF CECIL**  
31 **COUNTY, MARYLAND**, that this application to expand the Cecil County Enterprise Zone to  
32 include seven (7) parcels totaling 391.86 acres, more or less, as reflected in Exhibit A, as  
33 attached, is approved.

34           **AND BE IT HEREBY FURTHER RESOLVED BY THE COUNTY COUNCIL OF CECIL COUNTY,**  
35 **MARYLAND**, that this Resolution shall take effect on the date of its passage.

**INTRODUCED: February 15, 2022**

**ADOPTED: April 5, 2022**

  
\_\_\_\_\_  
President of the Council

ATTEST:

  
\_\_\_\_\_  
Council Manager

**Appendix 1 (Page 1 of 2)**  
**Cecil County, Maryland**

**Enterprise Zone Expansion - Northrop Grumman**

Print date = February 9, 2022  
 Scale: 1 inch = 1,000 feet

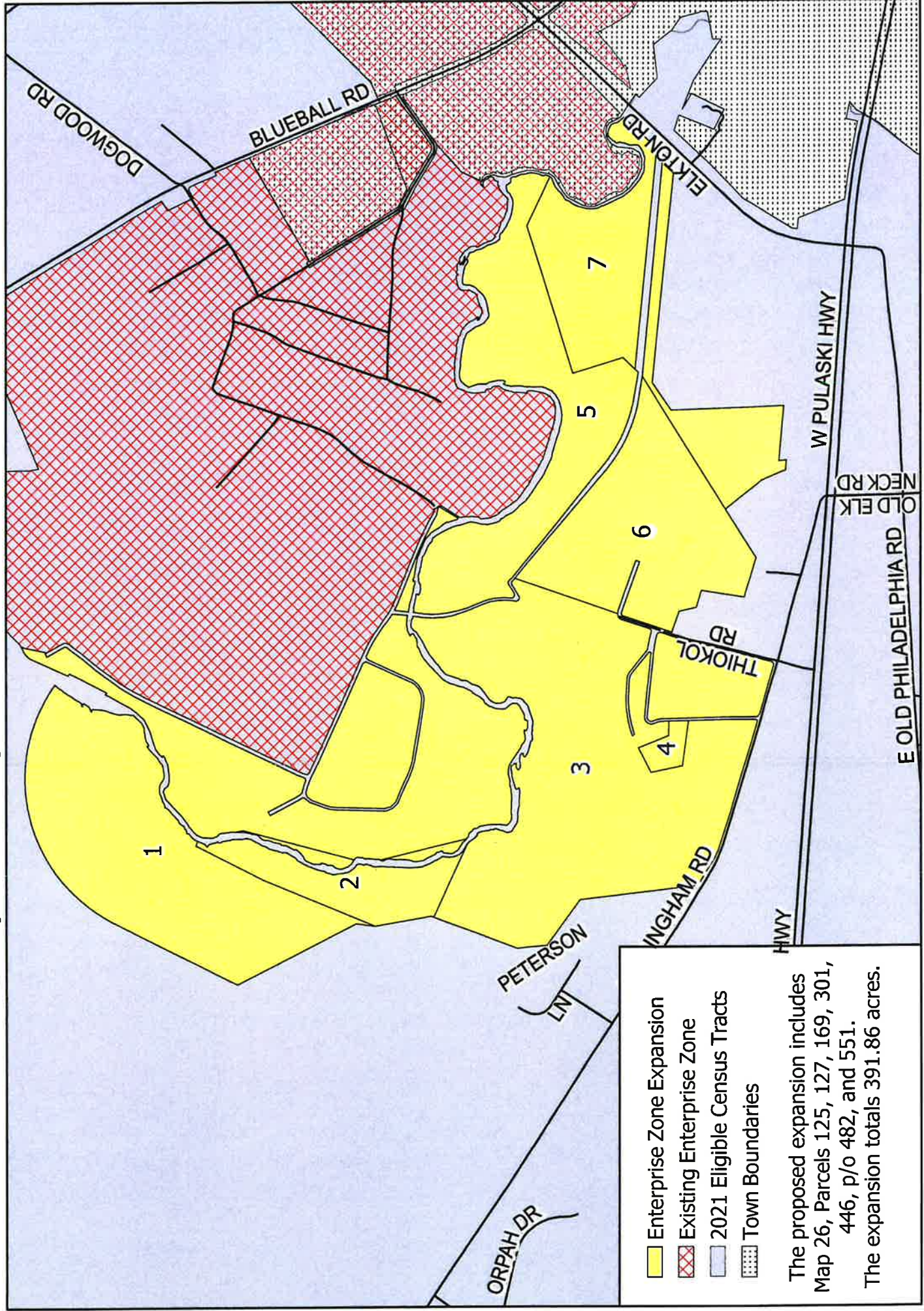

- Enterprise Zone Expansion
- Existing Enterprise Zone
- 2021 Eligible Census Tracts
- Town Boundaries

The proposed expansion includes Map 26, Parcels 125, 127, 169, 301, 446, p/o 482, and 551. The expansion totals 391.86 acres.





# Resolution 07-2022 Exhibit A Northrop Grumman / ATK / Thiokol Parcels - Location Relative to Enterprise Zone

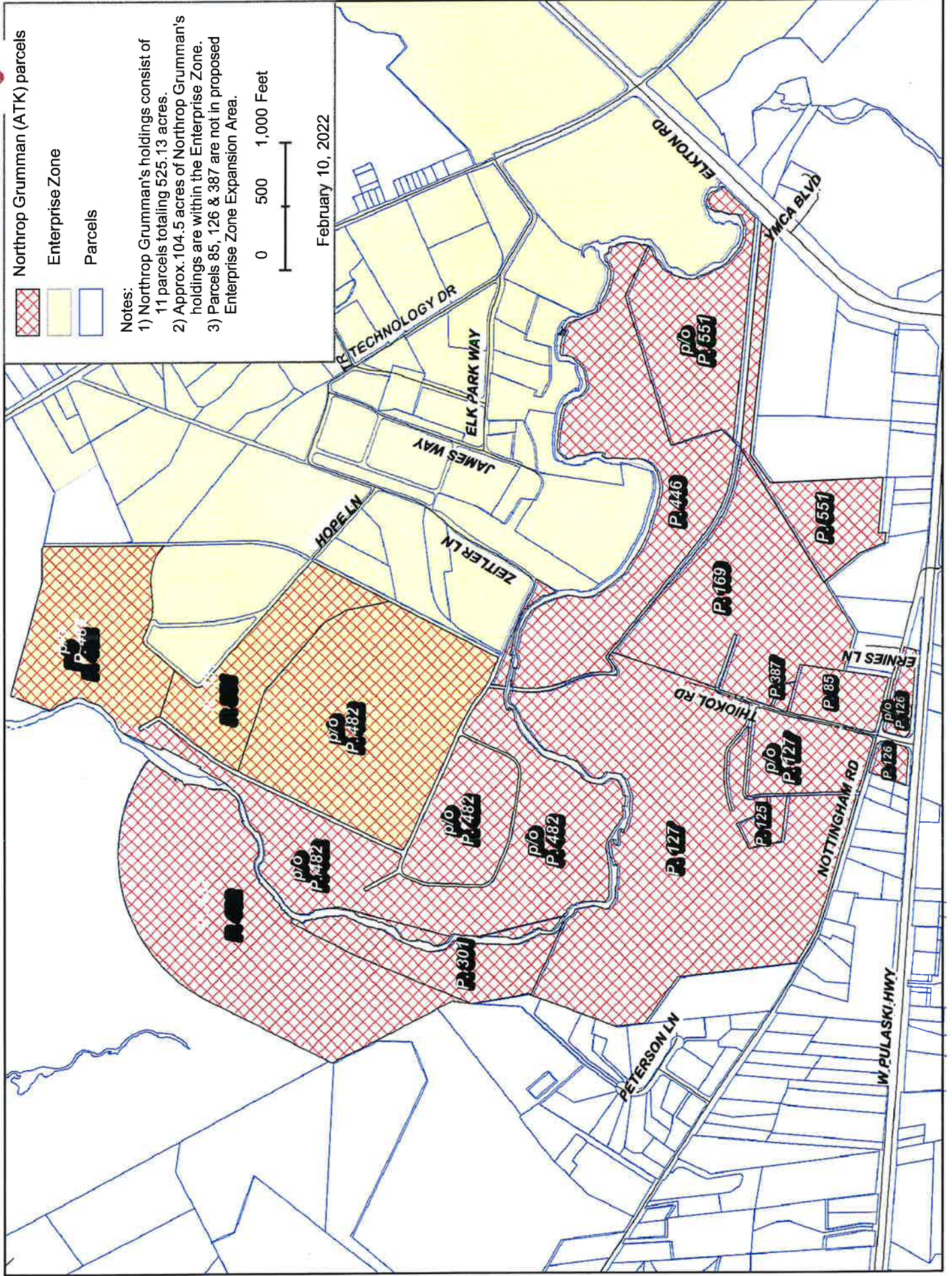

# Cecil County - Proposed Enterprise Zone Expansion Cecil County Zoning Map Exhibit B4 07-2022

Print date = February 9, 2022  
Scale: 1 inch = 1,250 feet  
Resolution 07-2022 Exhibit B

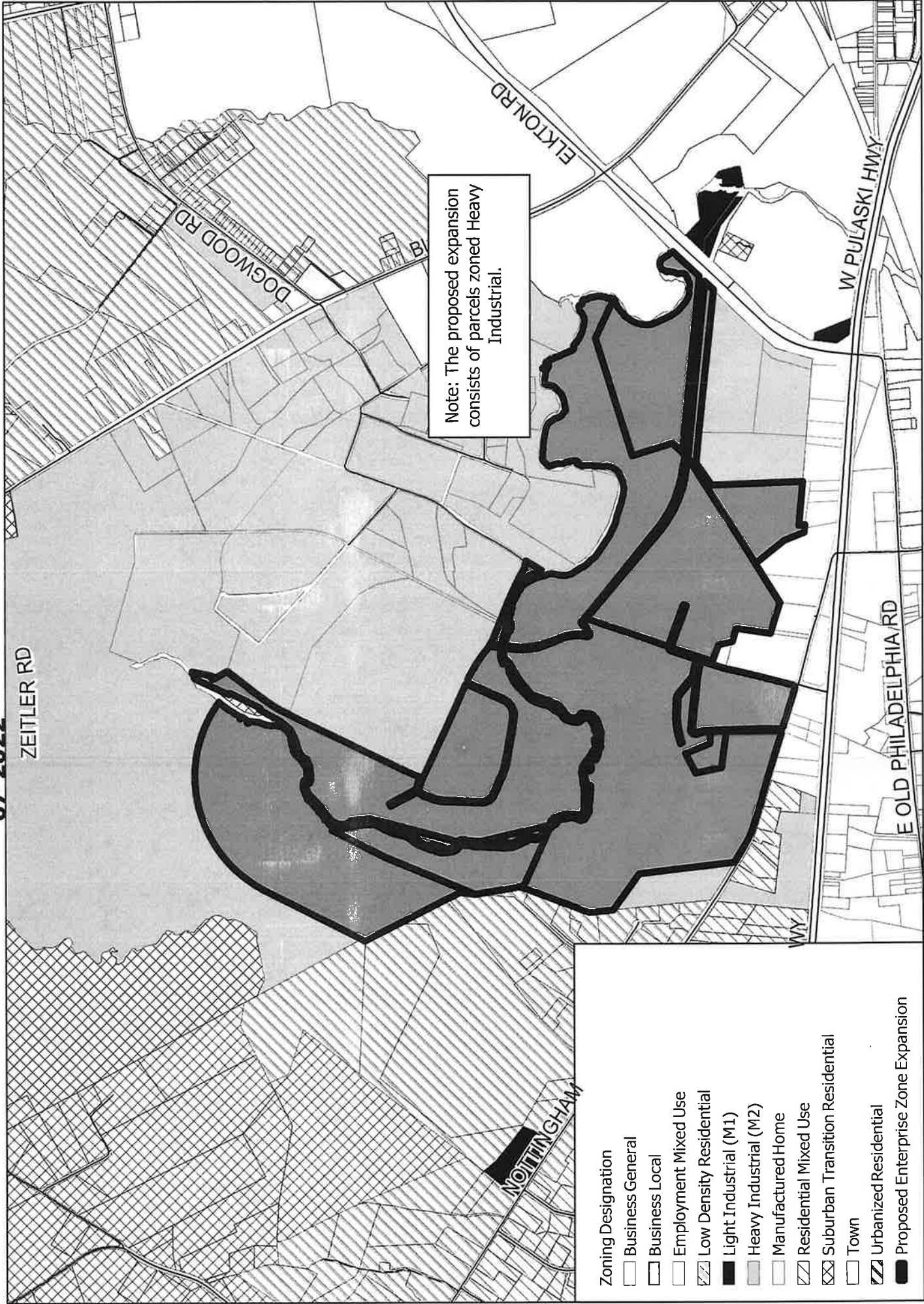

Note: The proposed expansion consists of parcels zoned Heavy Industrial.

- Zoning Designation**
- Business General
  - Business Local
  - Employment Mixed Use
  - Low Density Residential
  - Light Industrial (M1)
  - Heavy Industrial (M2)
  - Manufactured Home
  - Residential Mixed Use
  - Suburban Transition Residential
  - Town
  - Urbanized Residential
  - Proposed Enterprise Zone Expansion

**Cecil County, Maryland**  
**Proposed Enterprise Zone relative to**  
**Priority Funding Areas**  
**Exhibit C2 07-2022**

Print date = February 9, 2022  
 Scale: 1 inch = 10,000 feet  
 Resolution 07-2022 Exhibit C

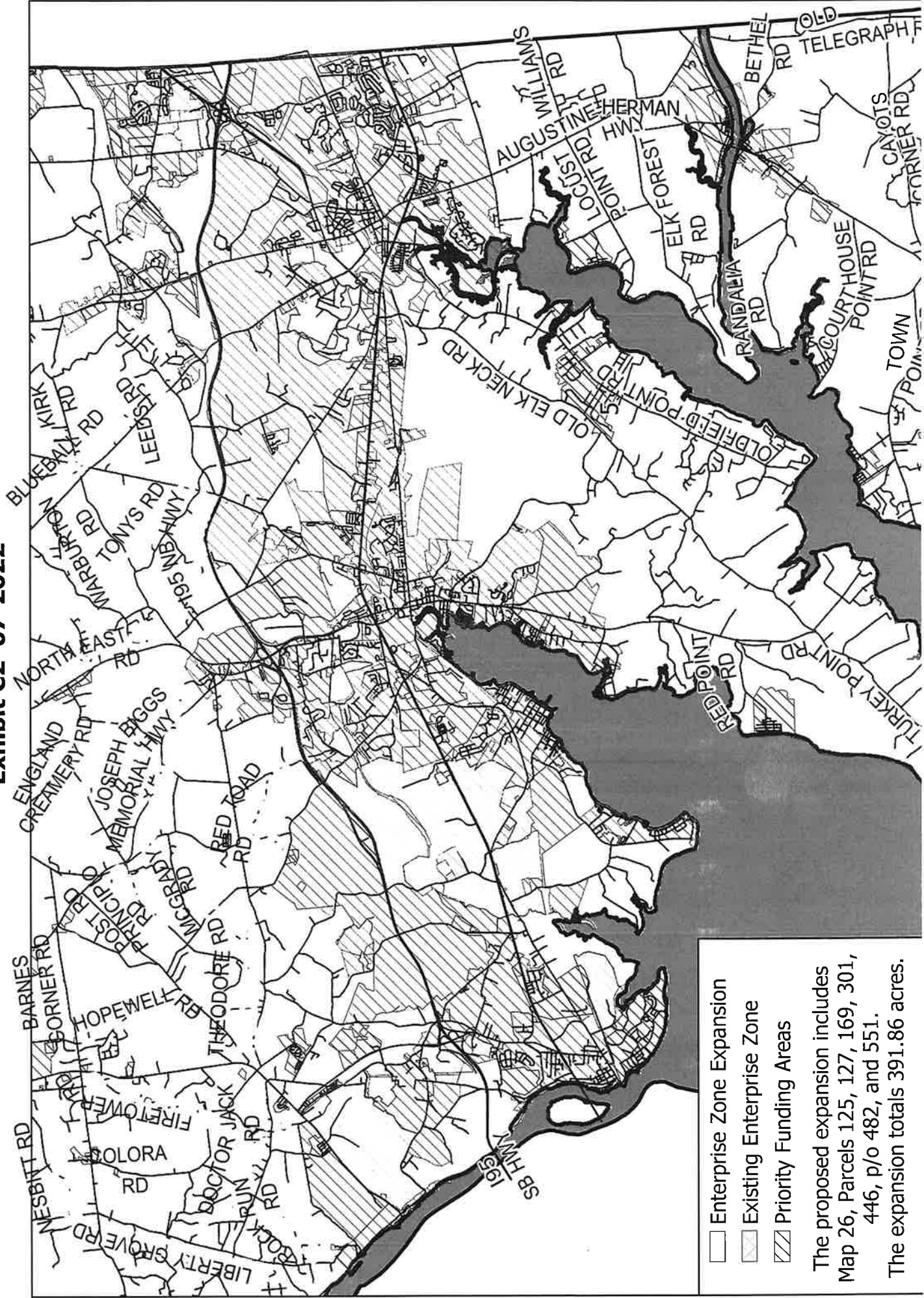

Enterprise Zone Expansion  
 Existing Enterprise Zone  
 Priority Funding Areas

The proposed expansion includes Map 26, Parcels 125, 127, 169, 301, 446, p/o 482, and 551. The expansion totals 391.86 acres.



# Cecil County, Maryland Proposed Enterprise Zone relative to Priority Funding Areas

Print date = February 9, 2022  
Scale: 1 inch = 10,000 feet  
Resolution 07-2022 Exhibit C

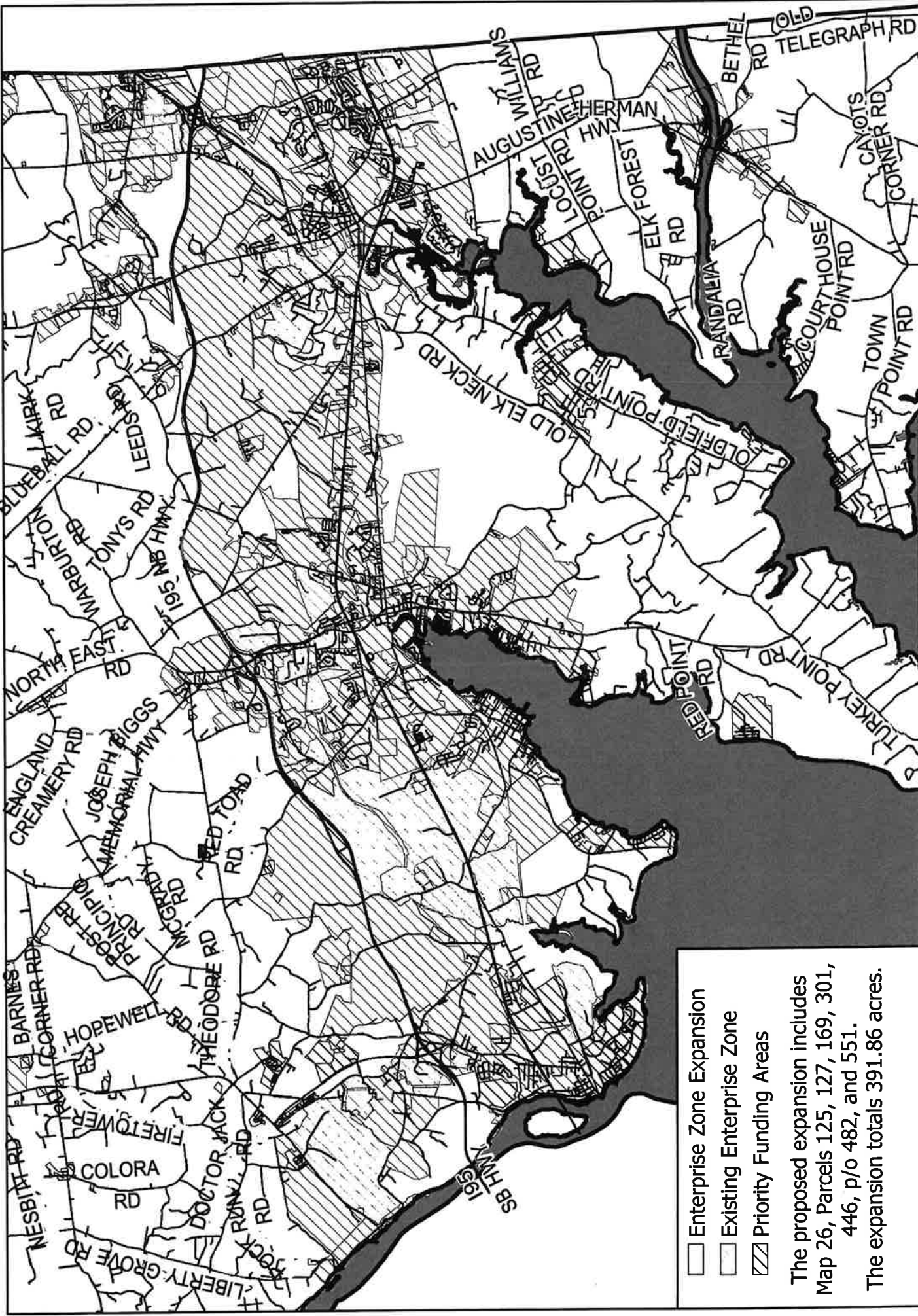

□ Enterprise Zone Expansion  
 □ Existing Enterprise Zone  
 ▨ Priority Funding Areas

The proposed expansion includes  
 Map 26, Parcels 125, 127, 169, 301,  
 446, p/o 482, and 551.  
 The expansion totals 391.86 acres.