



CECIL COUNTY
DEPARTMENT OF PUBLIC WORKS

NOTIFICATION OF ROAD/BRIDGE CLOSURE

ROAD NAME	<u>Big Elk Chapel Road</u>
BRIDGE NO.	<u>Culvert over Gramies Run</u>
CROSSING	<u>Gramies Run</u>
HOUSE #'S	<u>Closing between Silchester Drive and Gallagher Road</u>
Reason for Closure	<u>Culvert installation and improvements</u>
Date & Time	<u>October 21, 2019</u>
Duration of Closure (start/end)	<u>February 2020</u>
Detour Plan Attached	<u>YES</u> <u>NO</u>

EMERGENCY EQUIPMENT WILL/WILLNOT HAVE ACCESS

AGENCY / ENTITY CONDUCTING CLOSURE	<u>Department of Public Works- Engineering and Construction</u>
CONTACT PERSON	<u>Nick Candy (Turner Construction)</u>
CONTACT NUMBER	<u>410-715-7240</u>
RADIO OPS	<u></u>
PROJECT MANAGER	<u>N/A- Private Project</u>
CONTACT NUMBER	<u></u>

Questions: Please call the Contact Person listed above.
In the event you cannot reach the Contact Person please call the Project Manager.

COMMENTS: Installation of new box culvert as part of Fair Hill Fairground improvements.

FAIR HILL SPECIAL EVENT ZONE

DETOUR PLAN FOR ROAD CLOSURE OF BIG ELK CHAPEL ROAD FOR INSTALLATION OF BOX CULVERT AND ASSOCIATED IMPROVEMENTS AT GRAMIES RUN

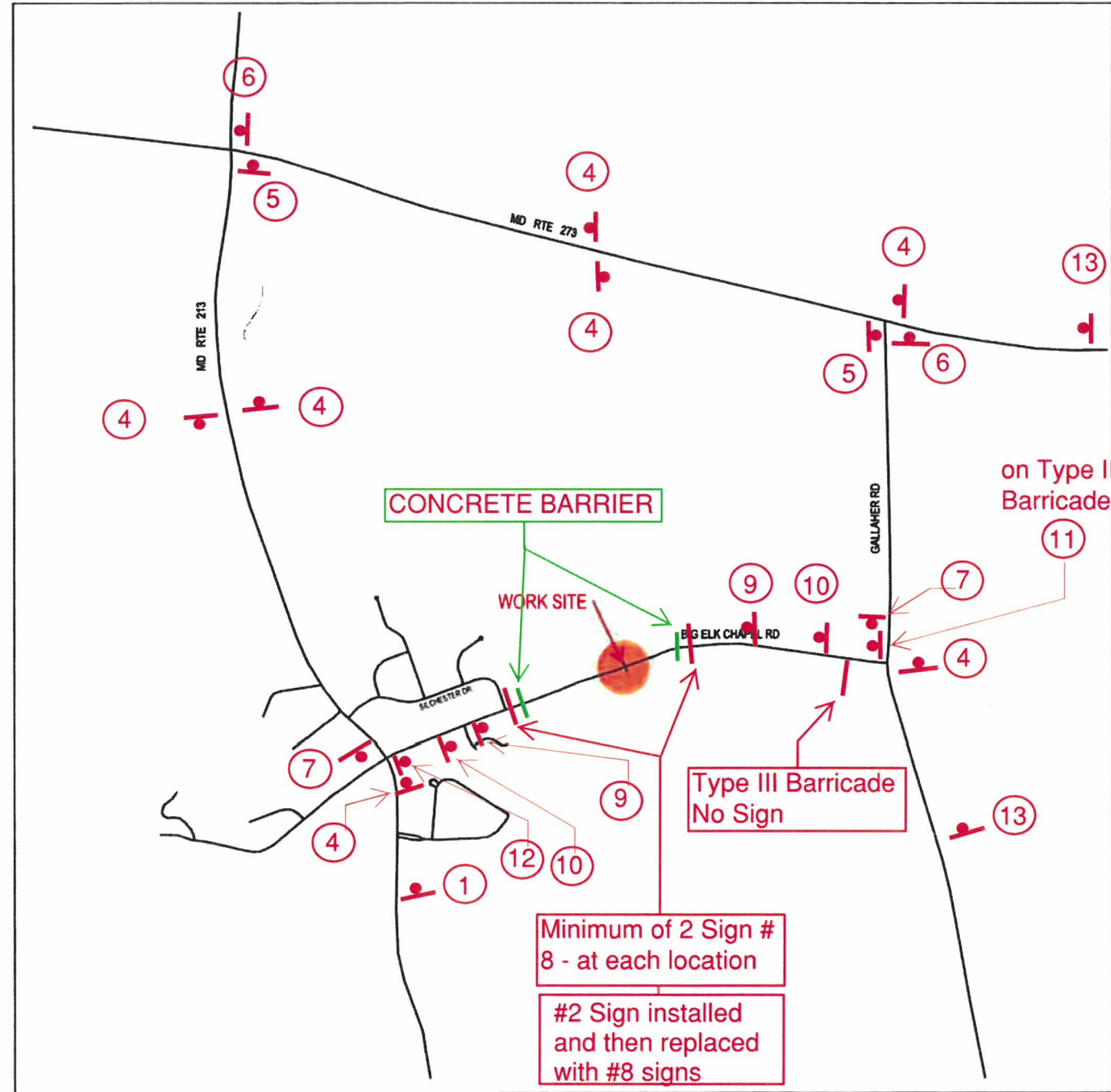

DETOUR PLAN
NOT TO SCALE

GENERAL NOTES

- 1 ALL SIGNS, BARRICADES, LIGHTS AND MOUNTING SUPPORTS AS DESIGNATED ON THE PLAN SHALL BE IN ACCORDANCE WITH CURRENT EDITION OF THE MUTCD (MANUAL ON UNIFORM TRAFFIC CONTROL DEVICES) AND THE MARYLAND SUPPLEMENT TO THE MUTCD.
- 2 CONTRACTOR MUST PROVIDE LOCAL ACCESS TO PROPERTIES WITHIN CONSTRUCTION AREA AT ALL TIMES, KIDDE ACADEMY AND OTHER BUSINESSES.
3. NOTICE SIGNS # 1 & 2 SHALL BE 60" X 48"
- 4 NOTICE SIGNS # 3 SHALL BE 60" X 36"
- 5 NOTICE SIGN #2 SHALL BE INSTALLED (2) WEEKS PRIOR TO THE CLOSURE
6. SPECIAL CARE SHALL BE TAKEN TO ENSURE THAT THE REQUIRED SIGNS DO NOT OBSTRUCT INTERSECTION SIGHT DISTANCE OR THE VIEW OF ANY EXISTING TRAFFIC CONTROL SIGN

SIGN # (1) #	NOTICE BIG ELK CHAPEL RD CLOSED AFTER SILCHESTER DRIVE FOLLOW DETOUR	60"
SIGN # (2) #	NOTICE BIG ELK CHAPEL RD TO BE CLOSED ON OR ABOUT (DATE)	60"
SIGN # (13) #	NOTICE BIG ELK CHAPEL RD CLOSED PRIOR TO SILCHESTER DRIVE FOLLOW DETOUR	60"
SIGN # (7) #	END DETOUR	**
SIGN # (8) #	TYPE III BARRICADE WITH "ROAD CLOSED" BARRICADE DETAIL (R11-2) NOT TO SCALE	WITH (2) - RED FLASHING LIGHTS
SIGN # (4) #	DETOUR ↑	**
SIGN # (5) #	BIG ELK CHAPEL ROAD DETOUR →	*
SIGN # (9) #	ROAD CLOSED 500 FT	***
SIGN # (10) #	ROAD CLOSED 1000 FT	***
SIGN # (6) #	BIG ELK CHAPEL ROAD DETOUR ←	**
SIGN # (11) #	ROAD CLOSED XX MILES AHEAD LOCAL TRAFFIC ONLY DETOUR →	R11-3A (48"x30") BLACK ON WHITE M4-10R (48"x18") BLACK ON ORANGE
SIGN # (12) #	ROAD CLOSED XX MILES AHEAD LOCAL TRAFFIC ONLY DETOUR ←	R11-3A (48"x30") BLACK ON WHITE M4-10L (48"x18") BLACK ON ORANGE

* BLACK ON WHITE
CECIL CO. ROADS (30" x 10")
SHA ROADS (48" x 12")

** BLACK ON FLUORESCENT ORANGE
CECIL CO. ROADS (30" x 24")
SHA ROADS (48" x 36")

*** BLACK ON FLUORESCENT ORANGE (36" x 36")
BLACK ON FLUORESCENT ORANGE (48" x 9") (6" LETTERS)

BLACK ON WHITE (4" LETTERS)
BLACK ON FLUORESCENT ORANGE (6" LETTERS)

