



CECIL COUNTY
DEPARTMENT OF PUBLIC WORKS

NOTIFICATION OF ROAD/BRIDGE CLOSURE

ROAD NAME Providence Road

BRIDGE NO. CE-0024

CROSSING Little Elk Creek Creek

HOUSE #'S House 119 Providence is EAST of Bridge, Kirk Road is WEST of Bridge

Reason for Closure Bridge Cleaning and Painting and Remedial Repairs

Date & Time Closing on or about July 29, 2019 at 9:00 am

Duration of Closure
(start/end) Opening end of August 2019

Detour Plan
Attached Yes

EMERGENCY EQUIPMENT WILL NOT HAVE ACCESS

AGENCY / ENTITY CONDUCTING CLOSURE Department of Public Works – Engineering and Construction Division

CONTACT PERSON Mike Ireson - Inspector

CONTACT NUMBER 410-996-8391

RADIO OPS 4

PROJECT MANAGER Jennifer Callaghan

CONTACT NUMBER 410-996-8113

Questions: Please call the Contact Person listed above.
In the event you cannot reach the Contact Person please call the Project Manager.

COMMENTS: Alan Salisbury will be on-site for closure. 443-309-1543

Project involves Cleaning/Painting and Minor Structural Repairs. Entire project duration is expected to be approximately 60 working days. Project is joint County and Federally funded.

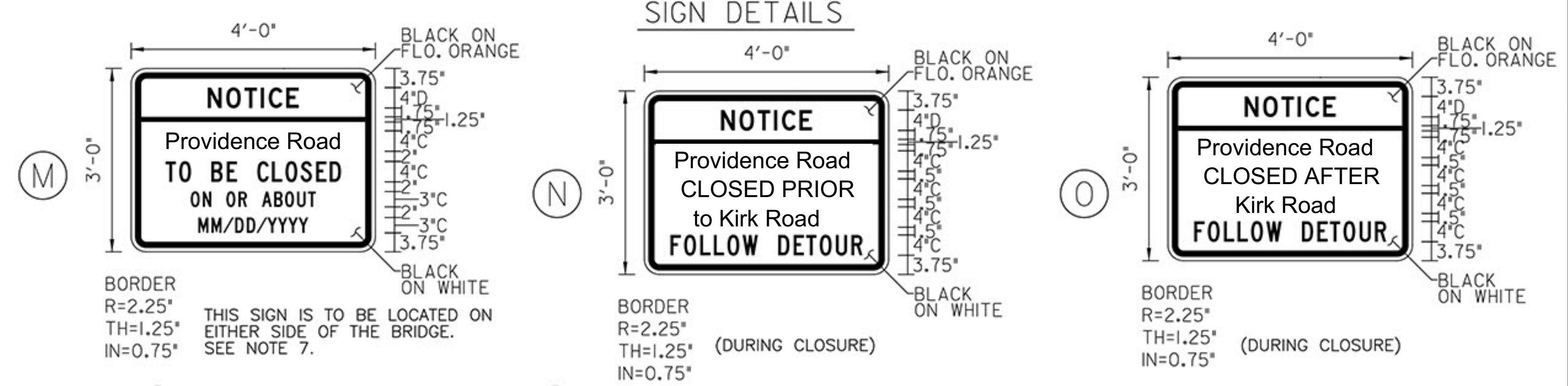
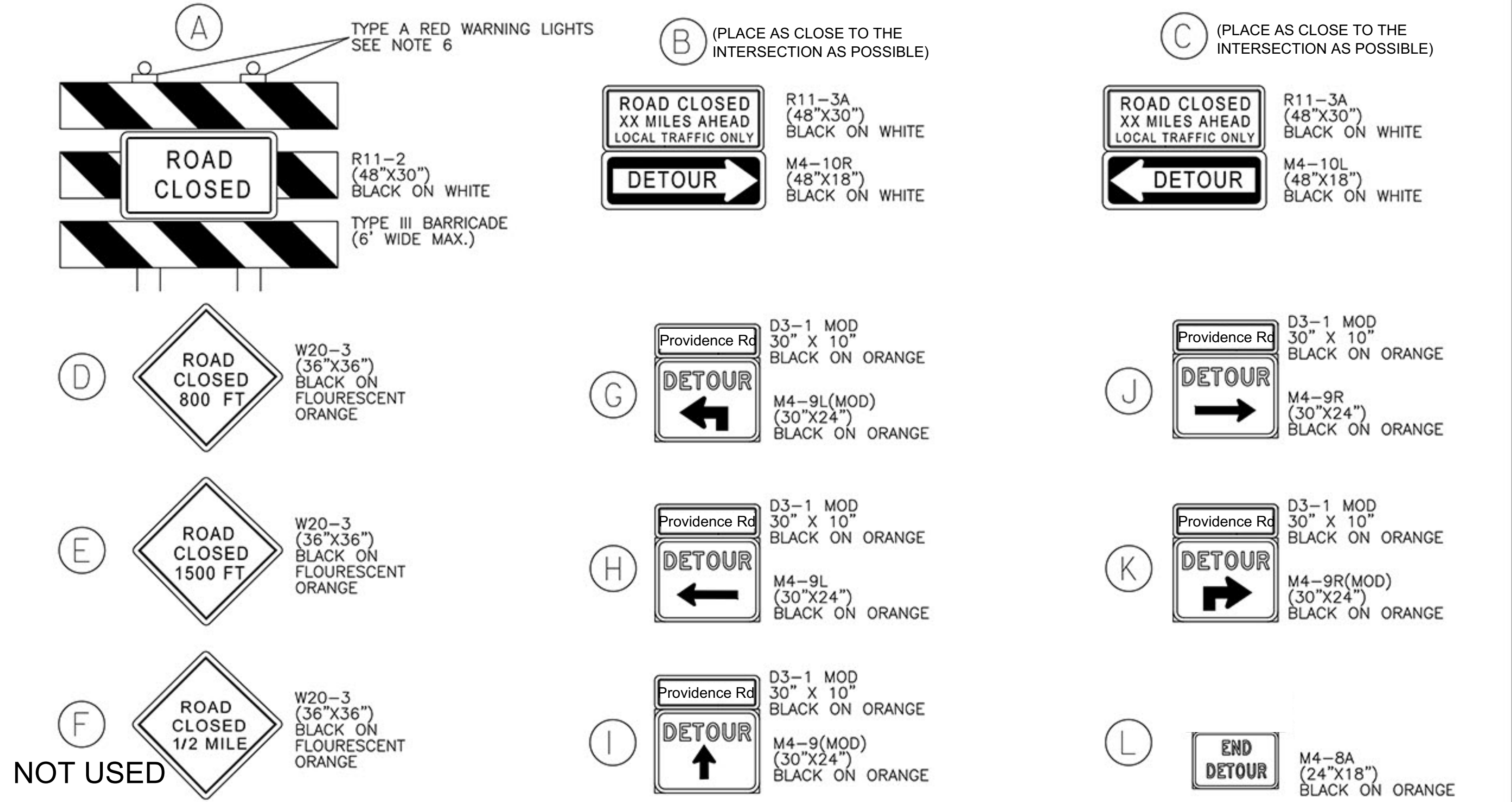
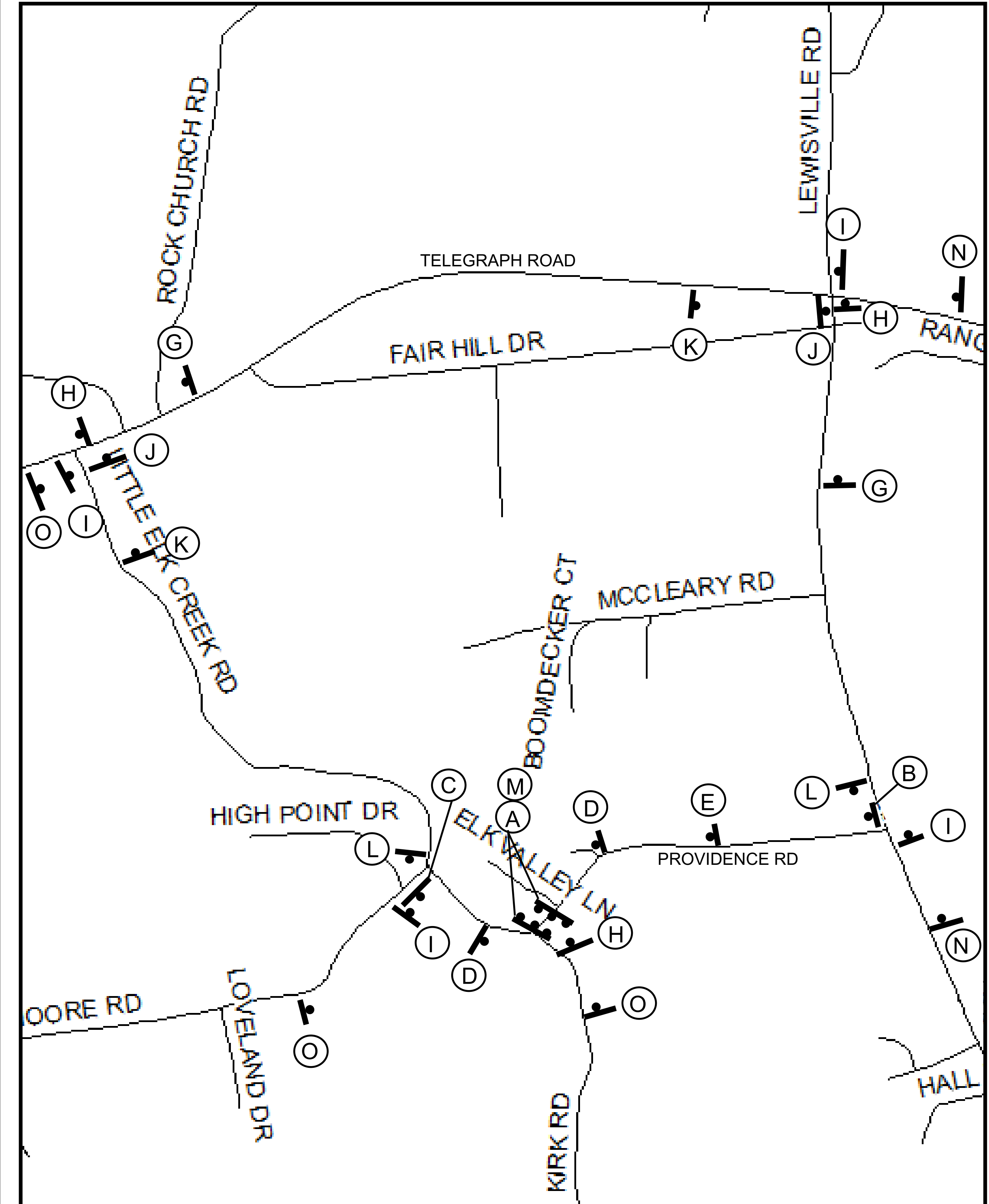

- DETOUR PLAN**
1. THE CONTRACTOR SHALL NOTIFY THE CECIL COUNTY DEPARTMENT OF PUBLIC WORKS 24 HOURS PRIOR TO IMPLEMENTING THIS PLAN.
 2. ALL WARNING SIGNS AND DETOUR ROUTE SIGNS SHALL BE PLACED PRIOR TO COMMENCING ANY WORK ON THE PROJECT. THEY SHALL BE COMPLETELY COVERED UNTIL APPLICABLE TO WORK.
 3. ALL WORK SHALL BE CONDUCTED IN ACCORDANCE WITH THE LATEST VERSION OF THE MARYLAND STATE HIGHWAY ADMINISTRATION'S (MSHA) BOOK OF STANDARDS FOR HIGHWAY AND INCIDENTAL STRUCTURES AND MSHA'S 2011 MARYLAND MANUAL ON UNIFORM TRAFFIC CONTROL DEVICES (MDMUTCD).
 4. ACCESS TO PRIVATE PROPERTY ENTRANCES SHALL BE MAINTAINED AT ALL TIMES.
 5. EXISTING ROUTE MARKERS AND ANY OTHER CONFLICTING DIRECTIONAL SIGNS SHALL BE COVERED OR REMOVED, THEN REPLACED WHEN THE DETOUR IS ELIMINATED.
 6. AT THE ROADWAY CLOSURE ONLY, INSTALL TYPE III BARRICADES WITH (2) FLASHING TYPE A LOW INTENSITY WARNING LIGHTS. SIGNS ON BARRICADE TO BE PAID FOR SEPARATELY. INSTALL TEMPORARY PRECAST DOUBLE FACE F-SHAPE CONCRETE BARRIER BEHIND TYPE III BARRICADE.
 7. INSTALL SIGN M A MINIMUM OF TWO WEEKS PRIOR TO BEGINNING WORK.
 8. THE LOCATION OF ALL SIGNS MUST BE APPROVED BY THE ENGINEER PRIOR TO INSTALLATION.

<p align="center">MOT LEGEND</p> <p> TEMPORARY SIGN MOUNTED ON WOOD SIGN SUPPORT</p> <p> TYPE III BARRICADE TWO ON EACH SIDE OF CLOSURE</p>		
<p align="center">CECIL COUNTY DEPARTMENT OF PUBLIC WORKS ENGINEERING AND CONSTRUCTION DIVISION</p> <p align="center">PROVIDENCE ROAD BRIDGE CE-0024</p> <p align="center">DETOUR PLAN</p>		
<p>DESIGNED BY: G. PECK</p> <p>DRAWN BY: G. PECK</p> <p>CHECKED BY: J. MOCNY</p> <p>F.A.P. NO.: STP-3(313)E</p>	<p>PROJECT NO.: 14-14-52023</p> <p>SCALE: 1" = 2000'</p> <p>DATE: SEPTEMBER 27, 2013</p>	
DRAWING NO. PS - 9	OF 9	SHEET NO. 11 OF 32

BY: ckatcoff