



CECIL COUNTY
DEPARTMENT OF PUBLIC WORKS

NOTIFICATION OF ROAD/BRIDGE CLOSURE

ROAD NAME Nazarene Camp Road - From 272 to South Leslie Drive

BRIDGE NO. _____

CROSSING _____

HOUSE #'S _____

Reason for Closure Road Re-alignment

Date & Time May 6, 2019

Duration of Closure (start/end) Approximately 5 months

Detour Plan Attached X- YES NO

EMERGENCY EQUIPMENT WILL NOT HAVE ACCESS

AGENCY / ENTITY CONDUCTING CLOSURE Department of Public Works- Engineering & Construction

CONTACT PERSON Mike Evans

CONTACT NUMBER 410-996-5268

RADIO OPS Mike Evans

PROJECT MANAGER 410-996-5268

CONTACT NUMBER _____

Questions: Please call the Contact Person listed above.
In the event you cannot reach the Contact Person please call the Project Manager.

COMMENTS: _____

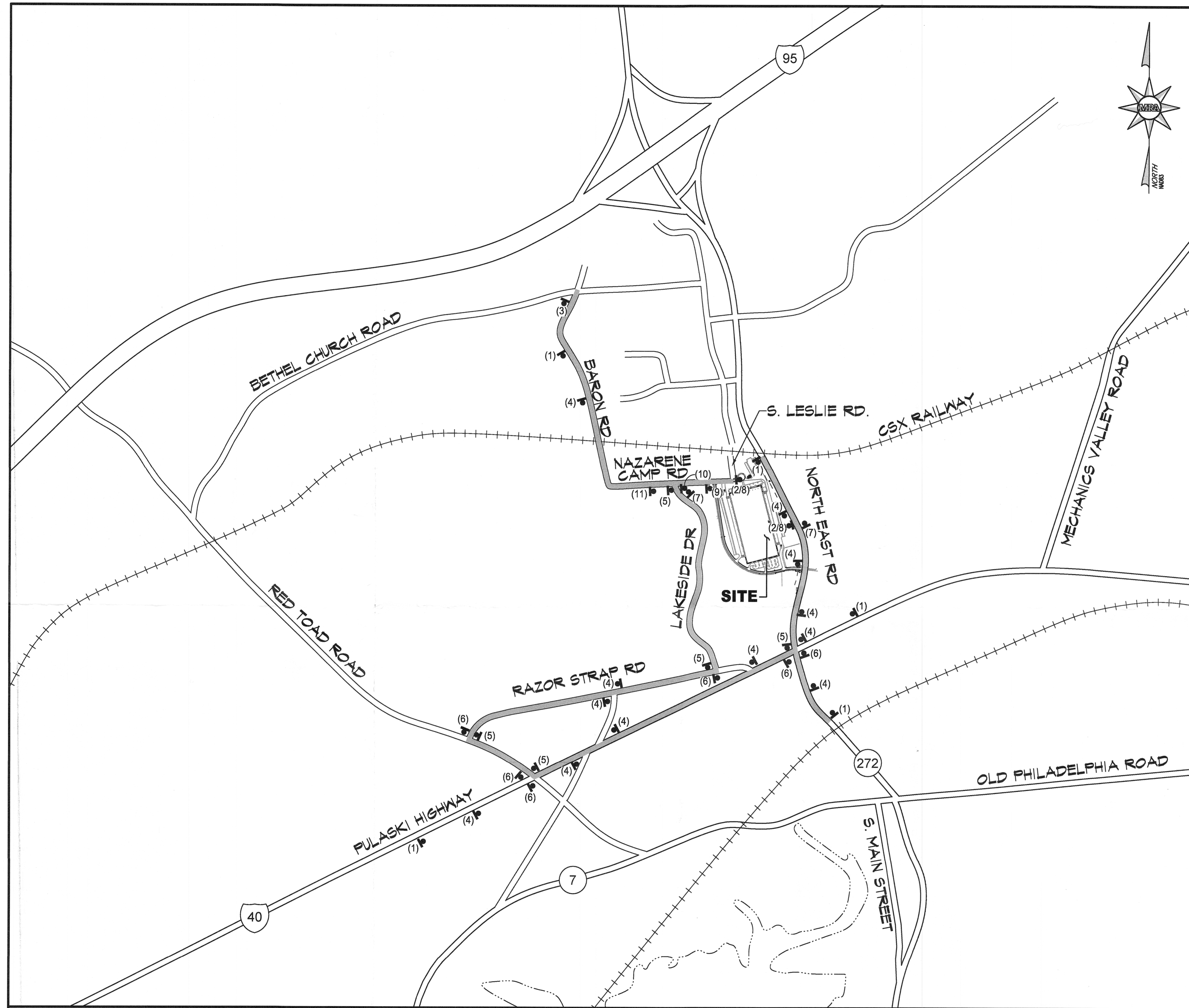

ROAD CLOSURE SIGNS

- SIGN #
- (1) B NOTICE
A NAZARENE CAMP ROAD CLOSED at XXXX ROAD FOLLOW DETOUR
- (2) B NOTICE
A NAZARENE CAMP ROAD TO BE CLOSED ON OR ABOUT (DATE) FOR APPROX. _____
- (3) B NOTICE
A ROAD CLOSED _____ MILES AHEAD

- A. BLACK ON WHITE 4" LETTERS
B. BLACK ON FLUORESCENT ORANGE 6" LETTERS
C. BLACK ON WHITE (30"x10")
D. BLACK ON FLUORESCENT ORANGE (30"x24")
E. BLACK ON FLUORESCENT ORANGE (36"x36")

NOTE:
1. NOTICE SIGNS #1, 2, 3 SHALL BE 48"x36" ON CECIL COUNTY ROADS AND 60"x48" ON STATE ROADS.
2. NOTICE SIGN #2 SHALL BE INSTALLED (2) WEEKS PRIOR TO THE CLOSURE.
3. SPECIAL CARE SHALL BE TAKEN TO ENSURE THAT THE REQUIRED SIGNS DO NOT OBSTRUCT INTERSECTION SIGHT DISTANCE OR THE VIEW OF ANY EXISTING TRAFFIC CONTROL SIGN.
4. ALL SIGNS (INCLUDING THE INSTALLATION) AND BARRICADES SHALL CONFORM TO THE LATEST ADDITION OF THE MUTCD (MANUAL ON UNIFORM TRAFFIC CONTROL DEVICES) AND THE MARYLAND SUPPLEMENT TO THE MUTCD.

- SIGN #
- (4) NAZARENE CAMP ROAD C
DETOUR D
↑
- (5) NAZARENE CAMP ROAD C
DETOUR D
→
- (6) NAZARENE CAMP ROAD C
DETOUR D
←
- (7) NAZARENE CAMP ROAD C
END DETOUR D
- (8) ROAD CLOSED (8)
TYPE III BARRICADE WITH "ROAD CLOSED" R11-2 TO BE INSTALLED TO COMPLETELY BLOCK THE ROADWAY AND SHALL BE FASTENED TOGETHER. INSTALL PORTABLE CONCRETE TRAFFIC BARRIERS BEHIND BARRICADE.
- (9) ROAD CLOSED 500 FT (9) E
- (10) ROAD CLOSED 1000 FT (10) E
- (11) ROAD CLOSED 1500 FT (11) E

ROAD CLOSURE PLAN - NAZARENE CAMP ROAD
SCALE: 1"=1000'



PROFESSIONAL CERTIFICATION
"I HEREBY CERTIFY THAT THESE DOCUMENTS WERE PREPARED OR APPROVED BY ME, AND THAT I AM A DULY LICENSED PROFESSIONAL ENGINEER UNDER THE LAWS OF THE STATE OF MARYLAND, LICENSE NO. 34672, EXPIRATION DATE: 08/23/2019."

PREPARED BY
MORRIS & RITCHIE ASSOCIATES, INC.
ENGINEERS, PLANNERS, SURVEYORS AND LANDSCAPE ARCHITECTS
3445-A BOX HILL CORPORATE CENTER DRIVE
ABINGDON, MD 21009
(410) 515-9000
FAX: (410) 515-9002
MRAGTA.COM
© 2019 MORRIS & RITCHIE ASSOCIATES, INC.

REVISIONS

MOT - DETOUR SHEET **DET - 1**

STATE OF MARYLAND
DEPARTMENT OF TRANSPORTATION
STATE HIGHWAY ADMINISTRATION
MD ROUTE 272 (NORTH EAST ROAD) - FRONTAGE IMPROVEMENTS
NORTH EAST GATEWAY

CONT. NO. 10-AP-CE-002-xx F.A.P. NO. SHEET NO. 17 OF 25
PREL. TRAC. BY AGD FINAL TRAC. BY BAW

C:\15866\CONSTRUCTION\SHA\15866_C_SHA-17-MOT-1-DETOUR.dwg, 3/13/2019 5:31:58 PM, B.Wiebar, 1:1, Copyright 2019 Morris & Ritchie Associates, Inc.