

Received
REZONING APPLICATION

OCT 12 2018

DATE FILED: 10/12/18 PC MTG: 11/19/18
AMT. PD: \$250.00 COUN.MTG:
ACCEPTED BY: JB FILE NO: 2018-04

Cecil County Office
of Planning & Zoning

APPLICANT INFORMATION

OWNER REPRESENTATIVE _____

DAWN + Gregory HARTZELL

APPLICANT NAME - please print clearly (additional names can be listed on page 2)

PHONE NUMBER _____

2108 Theodore Rd

Rising Sun

MD

21911

ADDRESS

CITY

STATE

ZIP CODE

PROPERTY INFORMATION

CRITICAL AREA? YES _____ NO

2108 Theodore Rd

Rising Sun

MD 21911

10.218

SUBJECT PROPERTY ADDRESS

SIZE OF PROPERTY

05

066409

24

6

219

LOT#

ELEC. DISTRICT

ACCOUNT#

TAX MAP#

BLOCK

PARCEL

PRESENT ZONING: RR

REQUESTED ZONING: NAR

PRESENT LAND USE DESIGNATION: RCD

REQUESTED LAND USE DESIGNATION: RCD

PRESENT USE OF PROPERTY: Farmette

PROPOSED USE OF PROPERTY: Farmette w/ Boarding Kennel

PREVIOUS ZONING CHANGE? YES _____ NO

If yes, explain: _____

TIME SCHEDULE FOR PROPOSED DEVELOPMENT: 2-3 yrs

REASON FOR REZONING REQUEST

MISTAKE IN THE COMPREHENSIVE REZONING OF MAY 1, 2011? YES _____ NO

IF YES, PLEASE EXPLAIN: Surrounded By NAR Properties been using Property AS A FARM Since 2008

SUBSTANTIAL CHANGE IN THE CHARACTER OF THE NEIGHBORHOOD? YES _____ NO

IF YES, PLEASE EXPLAIN: _____

MISTAKE IN CHESAPEAKE BAY CRITICAL AREA LAND USE DESIGNATION OF JULY 5, 1988 YES _____ NO

IF YES, PLEASE EXPLAIN: _____

ADDITIONAL COMMENTS (attached sheet if necessary): _____

EXPLAIN ANY PROBLEM AREAS AND PROPOSALS TO CORRECT THOSE AREAS

LIST THE NAME AND ADDRESSES OF ADDITIONAL APPLICANTS

Dawn Hartzell 2108 Theodore Rd Rising Sun MD
APPLICANT NAME (please print clearly) ADDRESS

Gregory Hartzell 2108 Theodore Rd Rising Sun MD
APPLICANT NAME ADDRESS

APPLICANT NAME ADDRESS

LIST THE NAME AND ADDRESSES OF ALL PROPERTY OWNERS

Same AS Above
OWNER NAME (please print clearly) ADDRESS

Same AS Above
OWNER NAME ADDRESS

OWNER NAME ADDRESS

OWNER NAME ADDRESS

CERTIFICATION - SIGNATURES

I/We certify that the information and exhibits submitted are true and correct to the best of my/our knowledge and belief.

APPLICANT(S):

<u>Dawn Hartzell</u> PRINT NAME	<u>Dawn Hartzell</u> SIGNATURE	<u>10-12-18</u> DATE
<u>Gregory Hartzell</u> PRINT NAME	<u>Gregory S Hartzell</u> SIGNATURE	<u>10-12-18</u> DATE
_____ PRINT NAME	_____ SIGNATURE	_____ DATE
_____ PRINT NAME	_____ SIGNATURE	_____ DATE

OWNER(S):

<u>Dawn Hartzell</u> PRINT NAME	<u>Dawn Hartzell</u> SIGNATURE	<u>10-12-18</u> DATE
<u>Gregory Hartzell</u> PRINT NAME	<u>Gregory Hartzell</u> SIGNATURE	<u>10-12-18</u> DATE
_____ PRINT NAME	_____ SIGNATURE	_____ DATE
_____ PRINT NAME	_____ SIGNATURE	_____ DATE

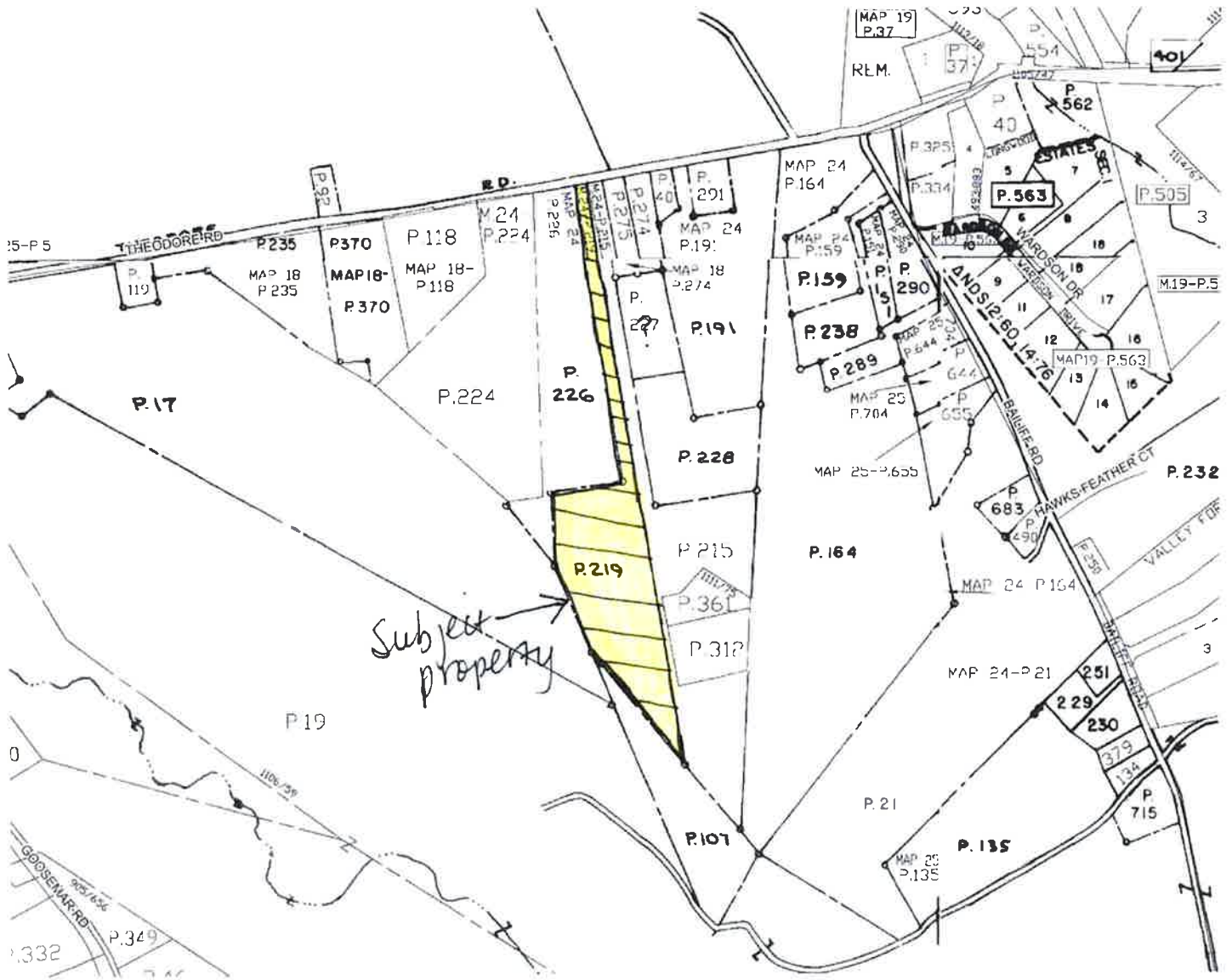

Subject property

